

Options table	
Theta limited stroke	365°
Wobble adjustment kit	No
Vacuum kit	No vacuum 2
Forks kit	Integrated
(PoGo pin) Connector rotative kit	No

It is required to assemble Vulcano 2 Stages on a granite or equivalent flat surface with a flatness inferior or equal to 5 microns

ETEL recommends to keep a clearance relative to the motion system's footprint of 60 mm for accessibility and servicing purpose, the minimum acceptable clearance being 20 mm.

1379598-01		ID number
Text		Change No. C137186-01
Original drawing		Revised:
Scale	Format	Material:
RoHS 2-5 A0	ASME-NNNN-08-0365-0355xx-XYZ3T STACKED S	
ASME-NNNN-08-0365-0355xx-XYZ3T STACKED S		
Dimensions in mm / Cotes en mm		Mating Dimensions / Cotes d'assemblage
Workpiece edges ISO 13715		General tolerances ISO 2768-mK
Arêtes de formes selon ISO 13715		Tolerances générales ISO 2768-mK
±0.3		±0.3
±0.3		±0.3
Tolerances as per ISO 8015 : 2011		Surface as per ISO 1302
Tolerances selon ISO 8015 : 2011		Surface de surface selon ISO 1302
		Surface treatment / Traitement de surface
The reproduction, distribution and utilization of this document as well as the communication of its contents to others without express authorization is prohibited. Offenders will be held liable for the payment of damages. All rights reserved in the event of the grant of a patent, utility model or design. (ISO 16016)		
ETEL S.A. 2112 Môtres SWITZERLAND		Version (Revision/Sheet) Page
1379598-00-A-01		Document number

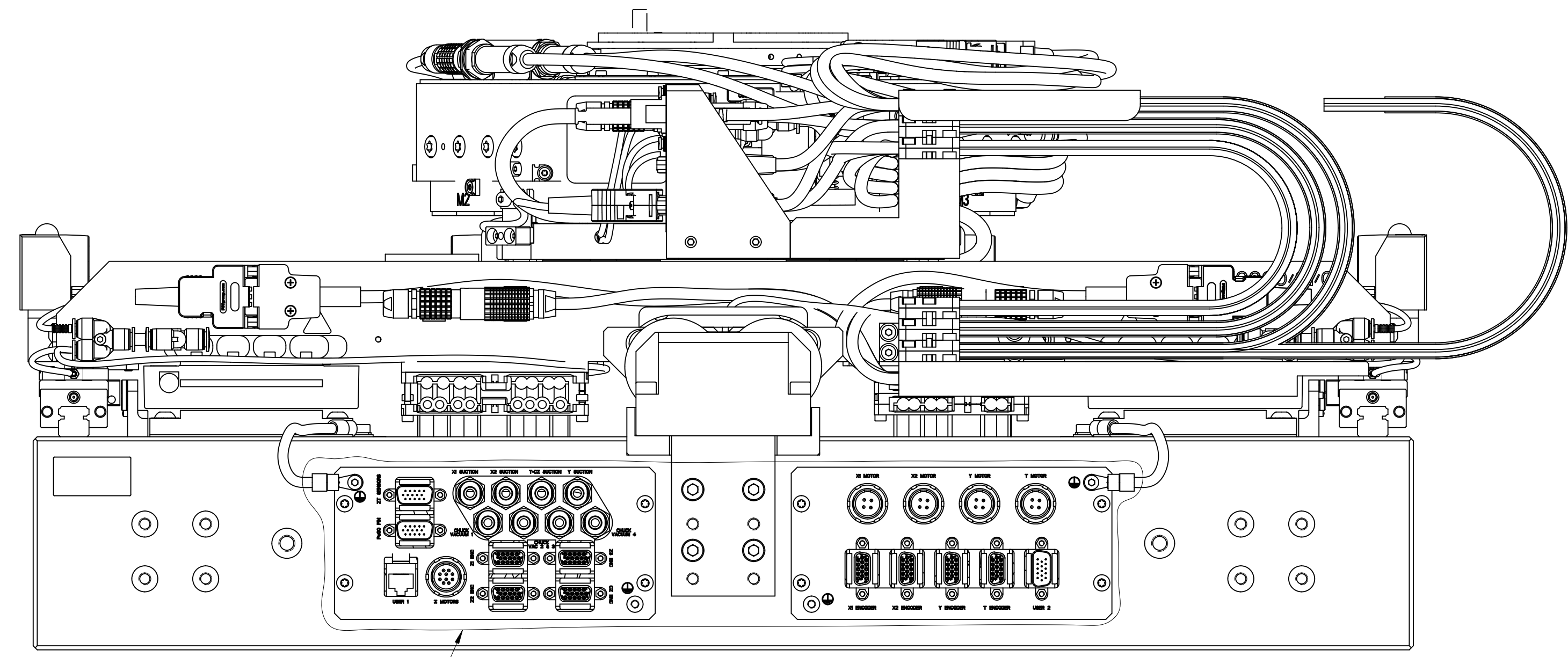

Front panel

1:2

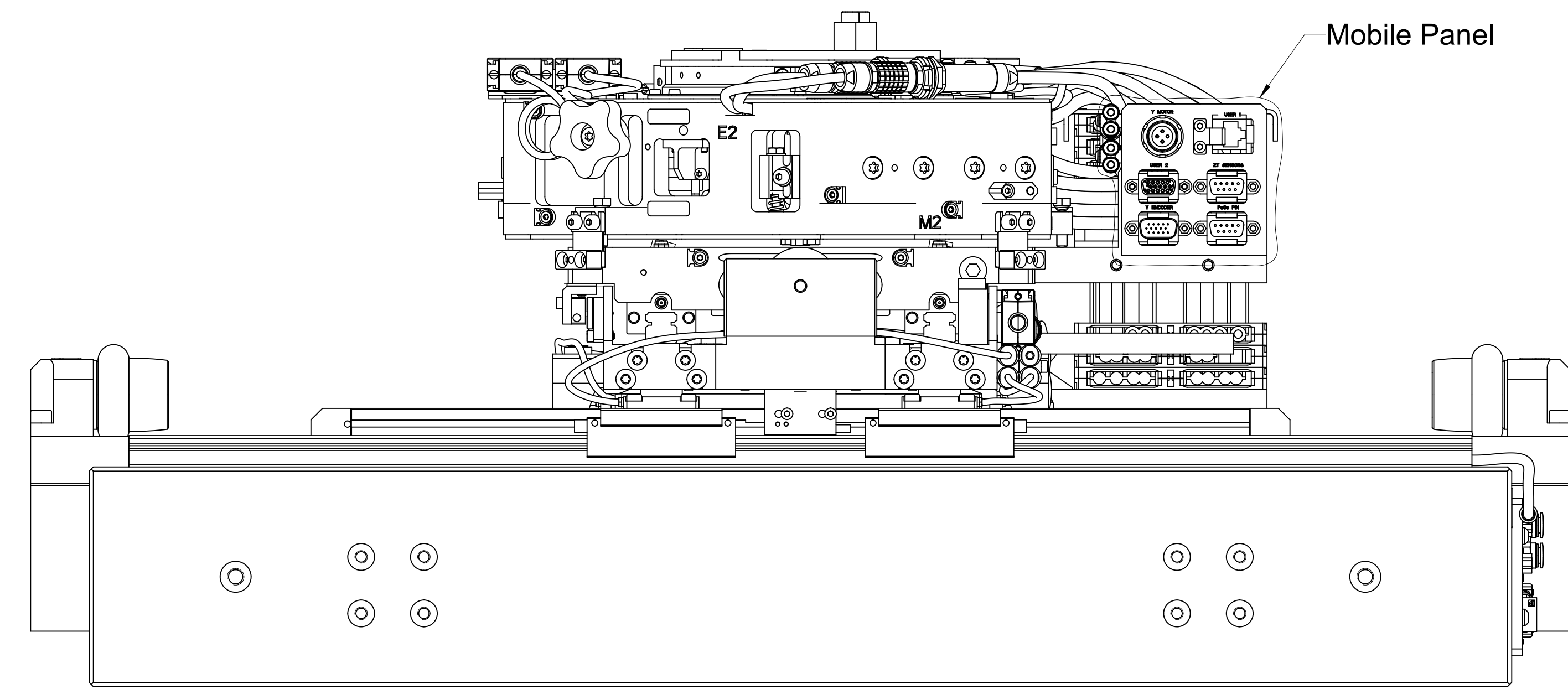

Mobile Panel

1:2

Front panel  
1:1

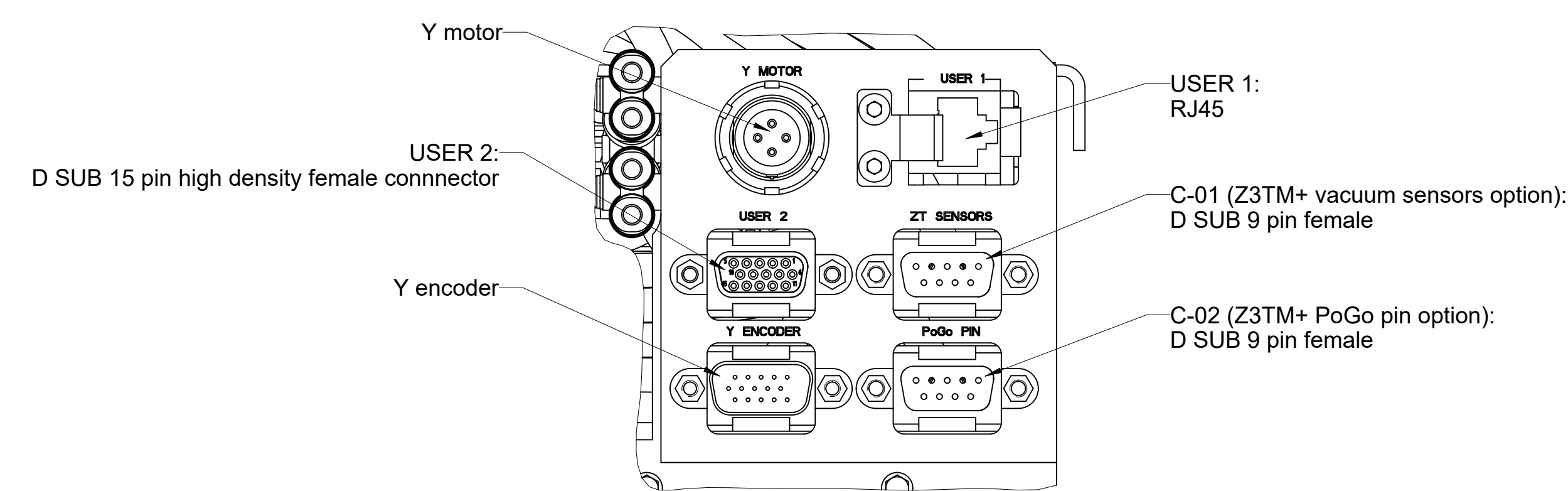
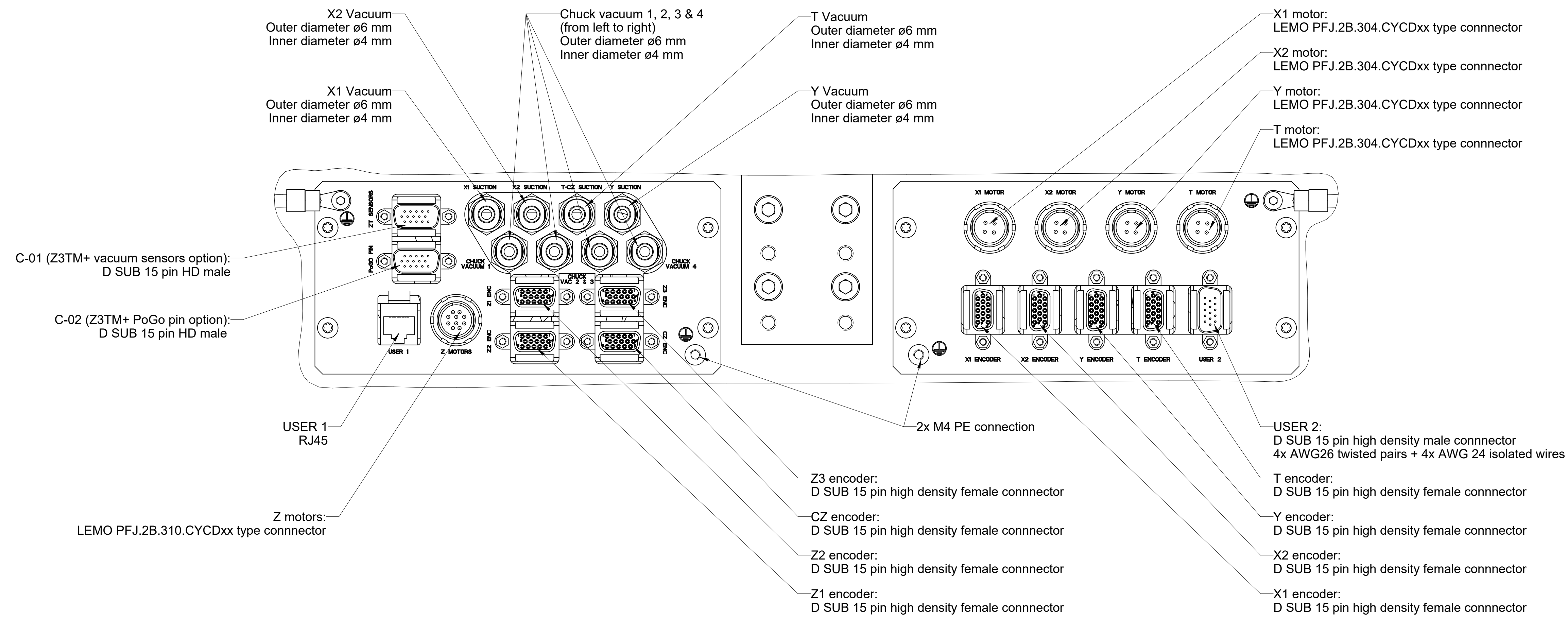

Mobile Panel  
6:5

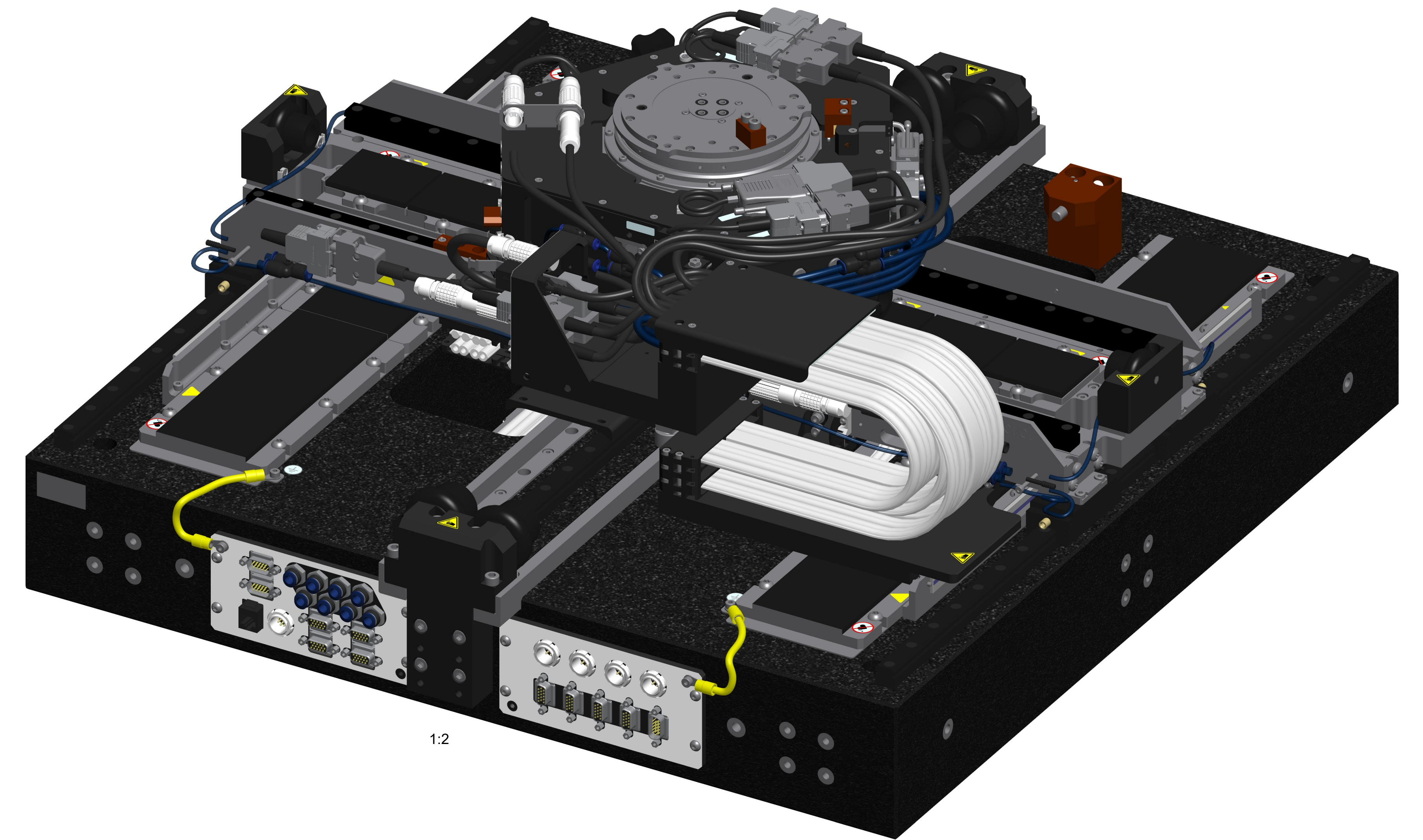

1:2

Text		ID number	
Original drawing	Scale	Format	Change No.
ASME-NNNN-08-0365-0355xx-XYZ3T STACKED S	2:5	A0	C137188-01
RoHS	Material		Revision:
ASME-NNNN-08-0365-0355xx-XYZ3T STACKED S			Material:
Dimensions in mm / Cotés en mm		Mating Dimensions / Cotés d'assemblage	
Workpiece edges ISO 13715		Surface as per ISO 1302	
Arêtes de formes selon ISO 13715		États de surface selon ISO 1302	
Tolerances as per ISO 8015 : 2011		Surface treatment:	
Tolérances selon ISO 8015 : 2011		Traitement de surface:	
The reproduction, distribution and utilization of this document as well as the communication of its contents to others without express authorization is prohibited. Offenders will be held liable for the payment of damages. All rights reserved in the event of the grant of a patent, utility model or design. (ISO 15016)			
ETEL S.A. 2112 Môtres SWITZERLAND		Version (Revision/Sheet) Page 1379598-00-A-01 2 of 2	

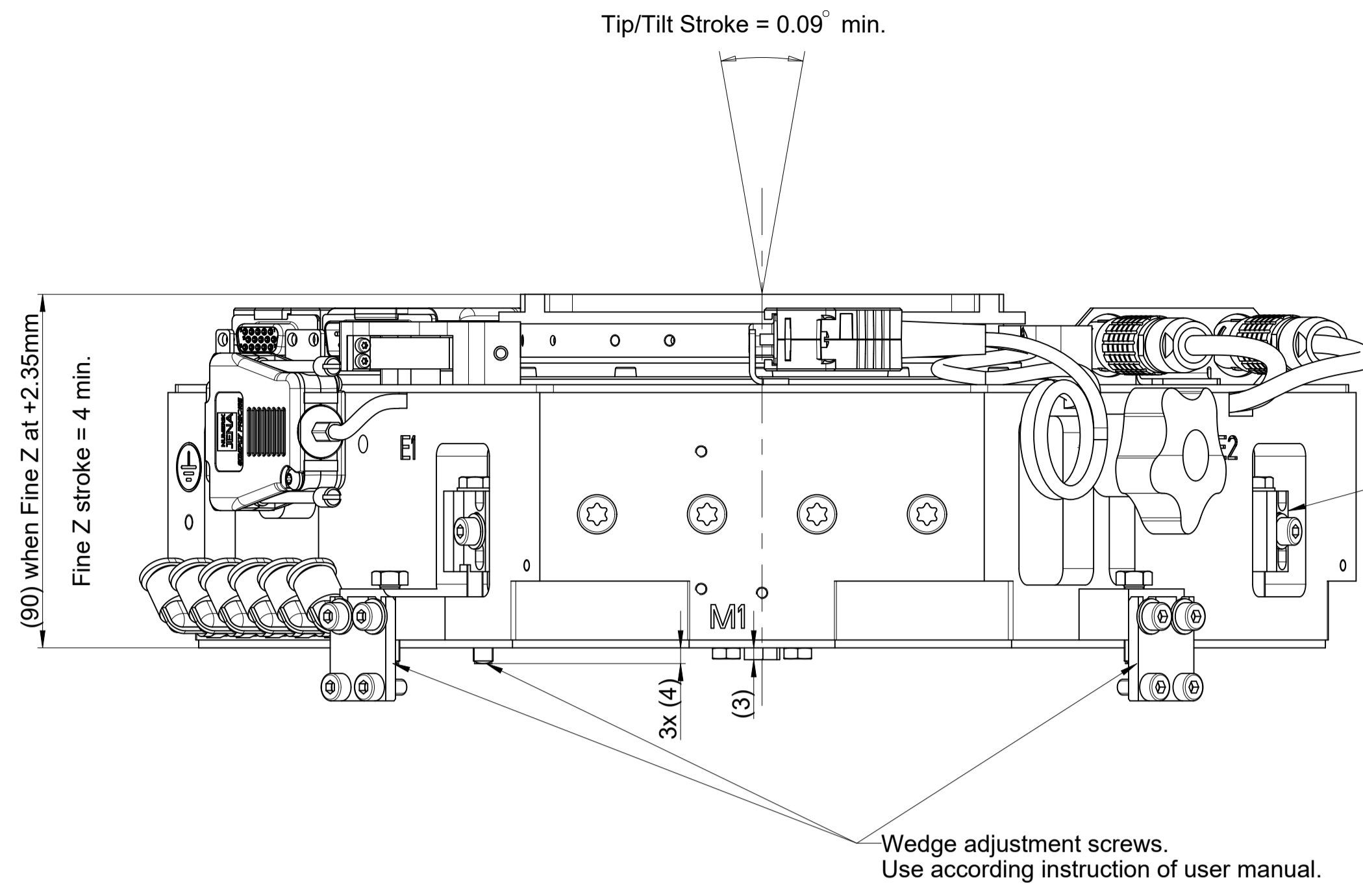

Fine Z top hardstop adjustment system.  
Use according instruction of user manual.

Wedge adjustment screws.  
Use according instruction of user manual.

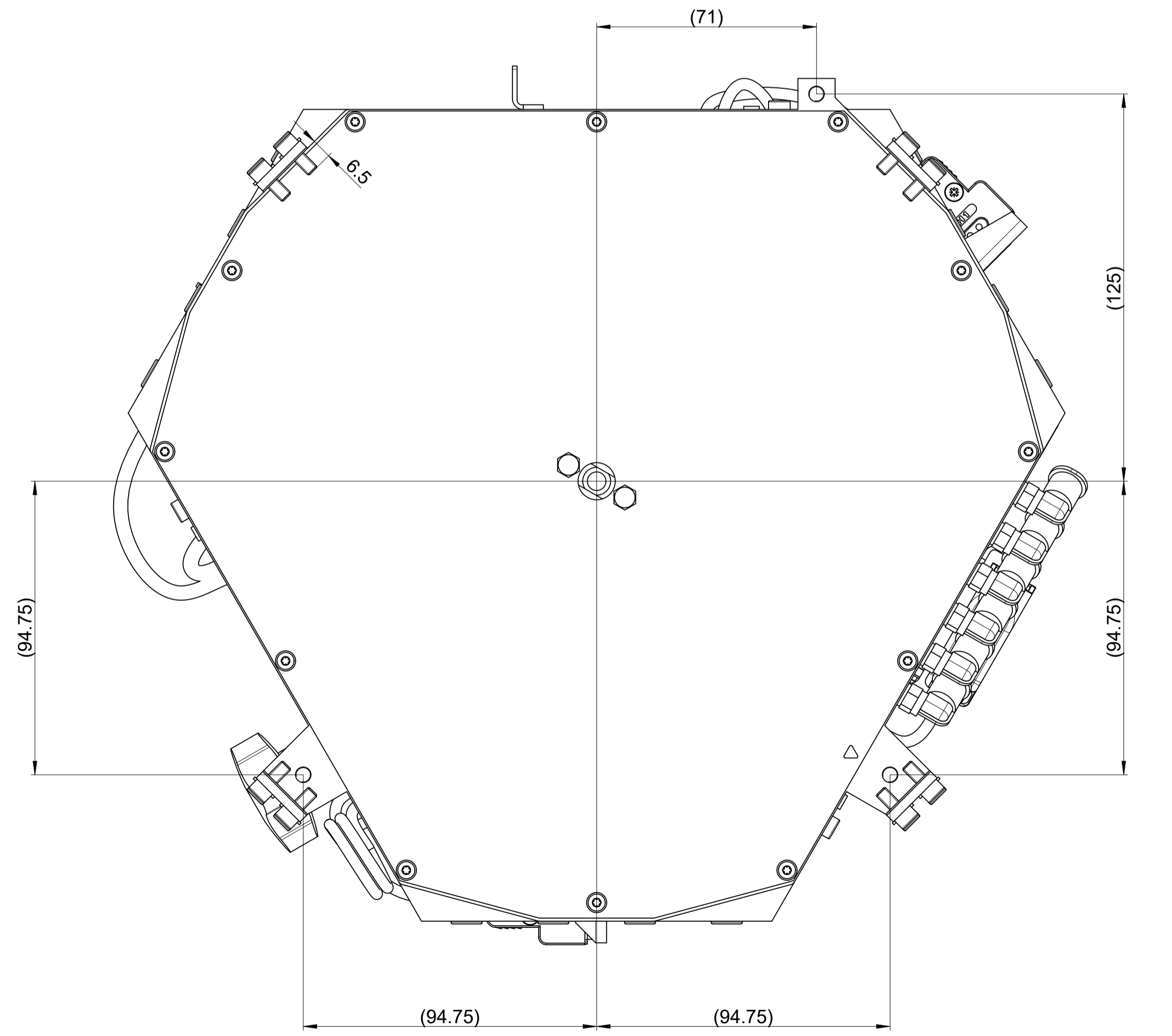
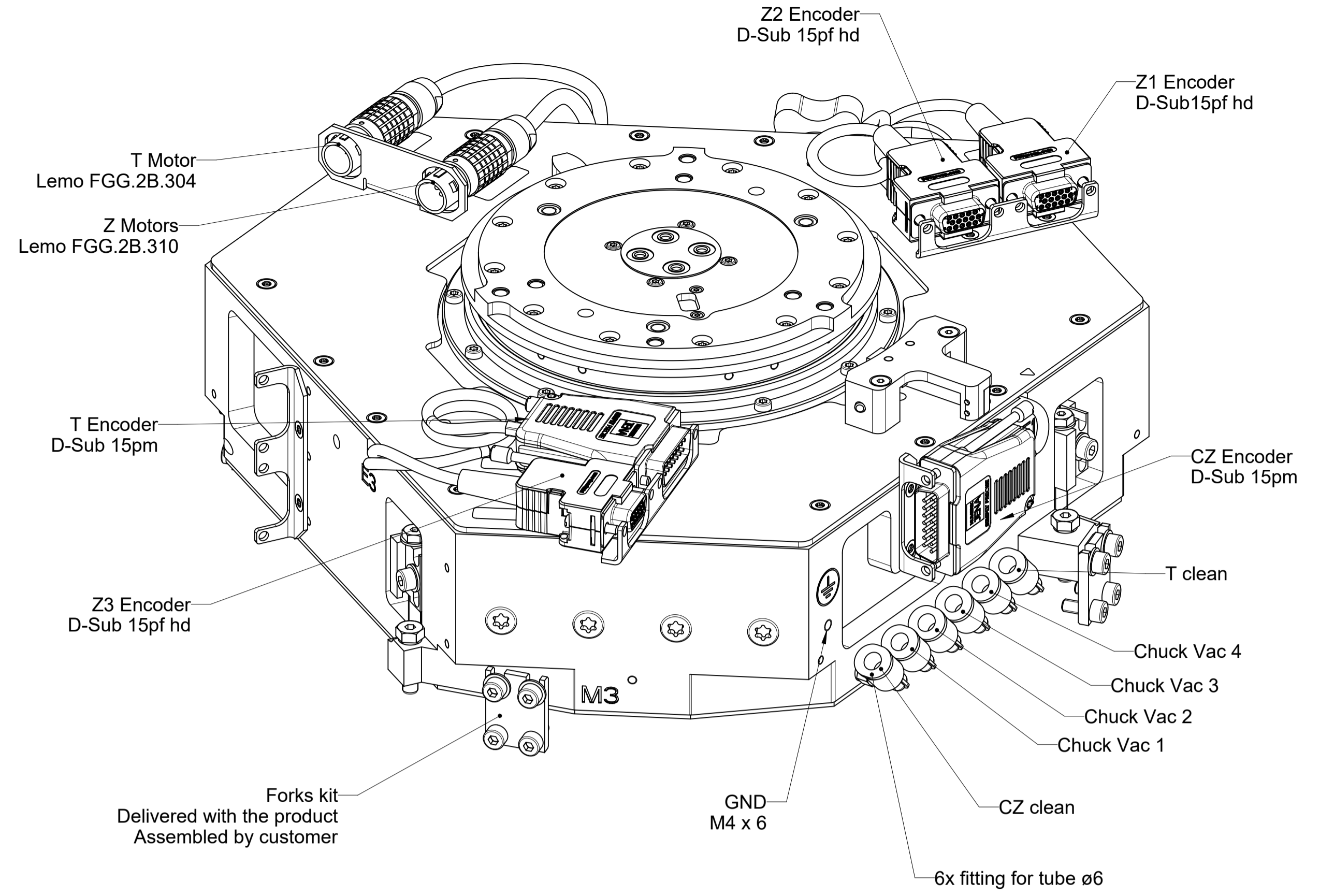
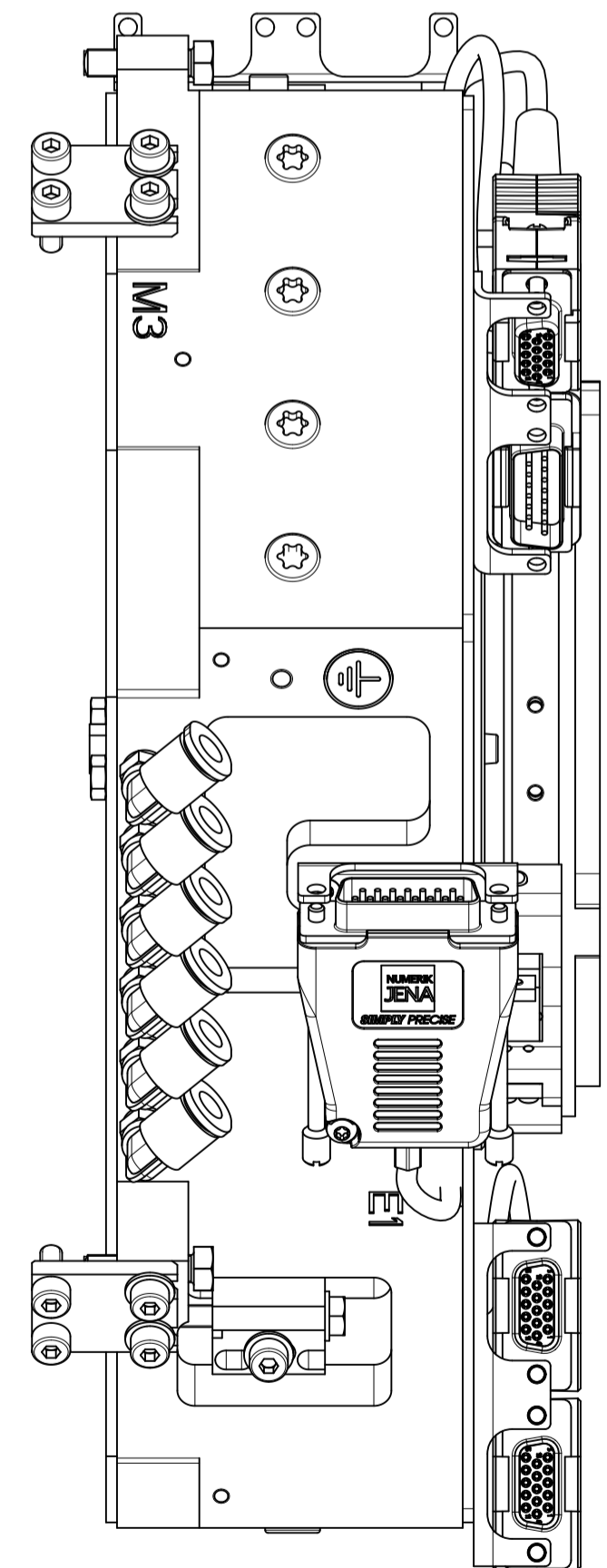
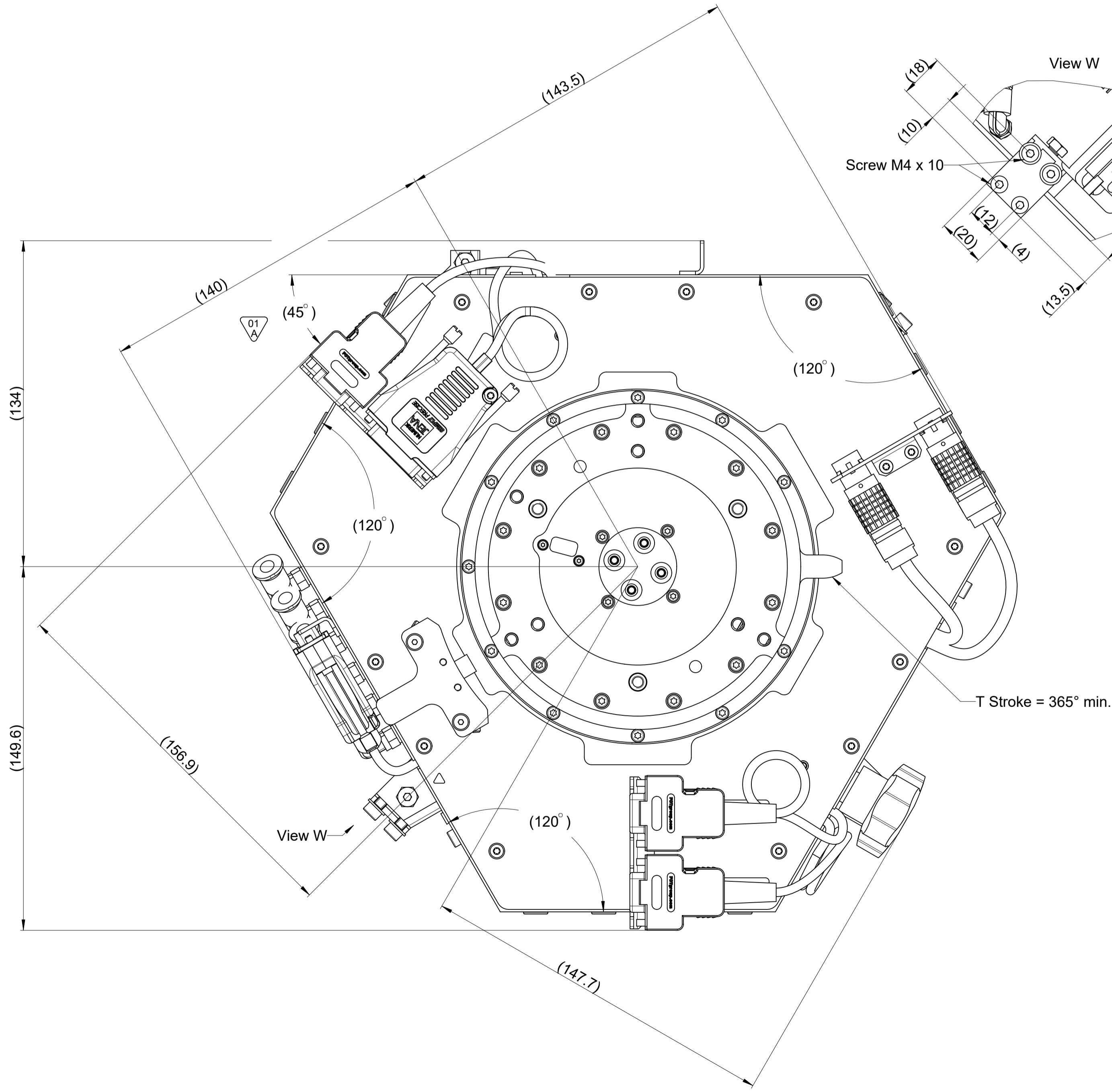
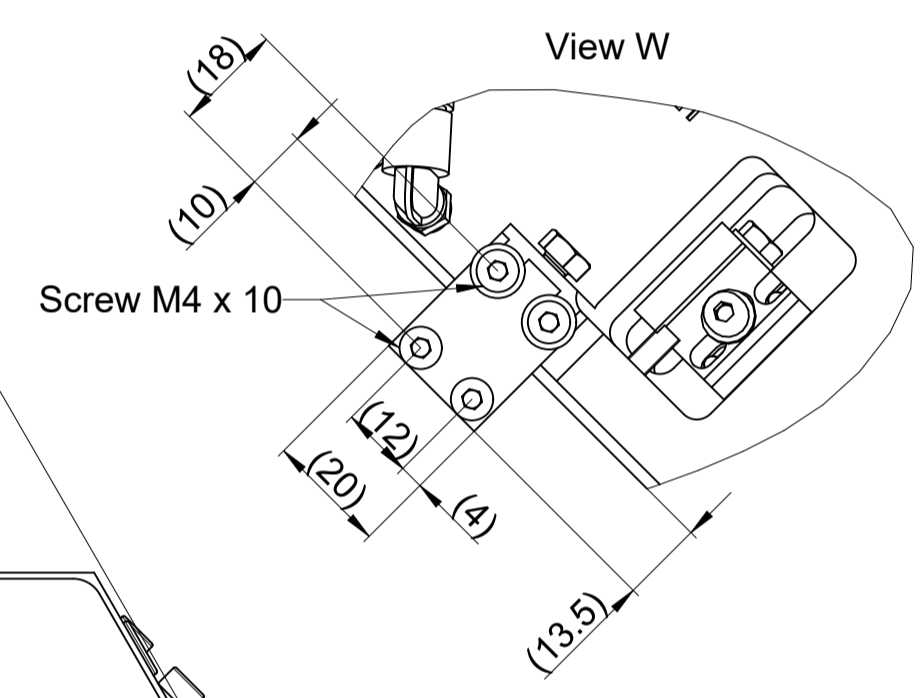

Text: Change orientation User C01 and C02 D-sub + add note screw penetration max		ID number: 1324806-
Change No. C138130-05		Released: 16-Mar-22
<p align="center"><b>Multi axis system Z3TM+</b> <b>Système multi-axes Z3TM+</b></p> <p align="center">Mating Dimensions / Cotes d'encastrement</p>		<p>Tolerances as per ISO 8015 : 2011 Tolérances selon ISO 8015 : 2011</p> <p>Dimensions without tolerance Dimensions sans tolérances</p>
<p>Original drawing</p> <p>Scale: 4:5</p> <p>Format: A1</p>	<p>The reproduction, distribution and utilization of this document as well as the communication of its contents to others without express authorization is prohibited. Offenders will be held liable for the payment of damages. All rights reserved in the event of the grant of a patent, utility model or design. (ISO 18015)</p>	
<p><b>ETEL</b> ETEL S.A. 2112 Möllers SWITZERLAND</p>		<p>Version   Revision   Sheet   Page</p> <p>1326462-01 - A-01 1 of 3</p>

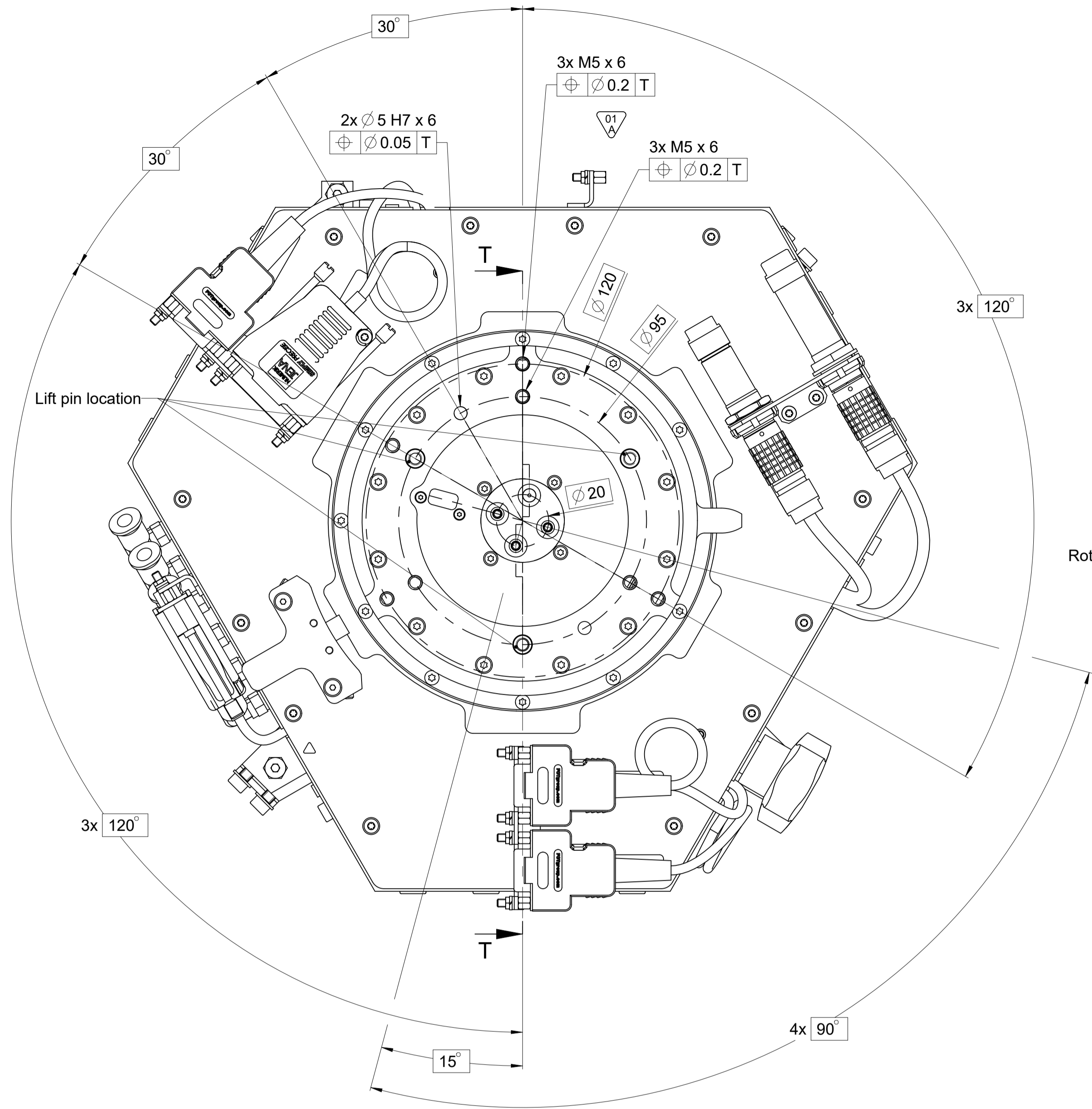

Customer fitting or part of chuck

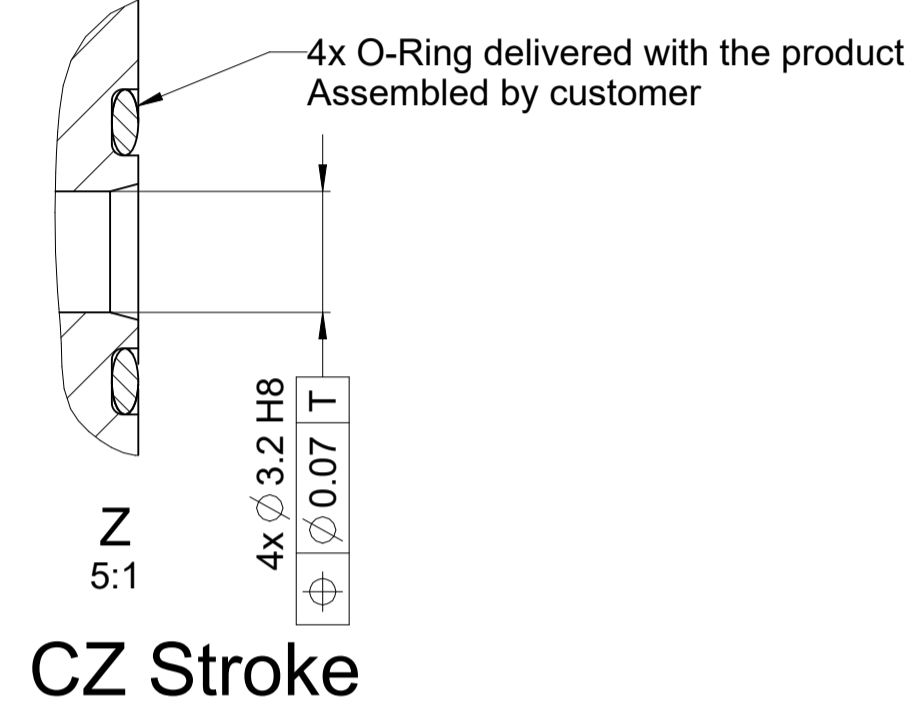
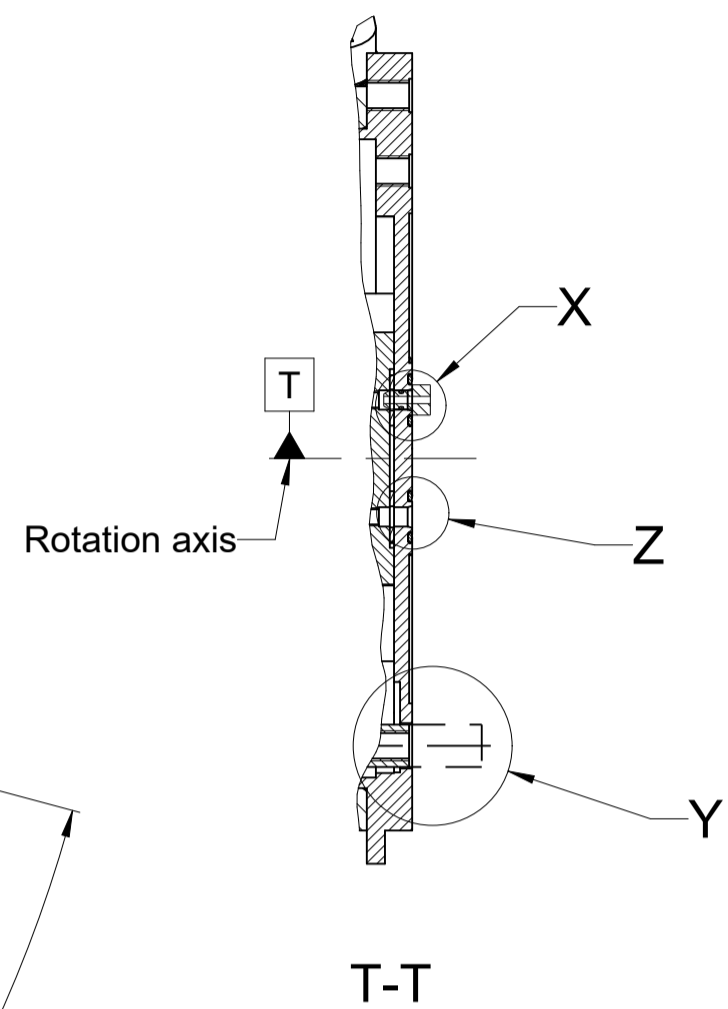
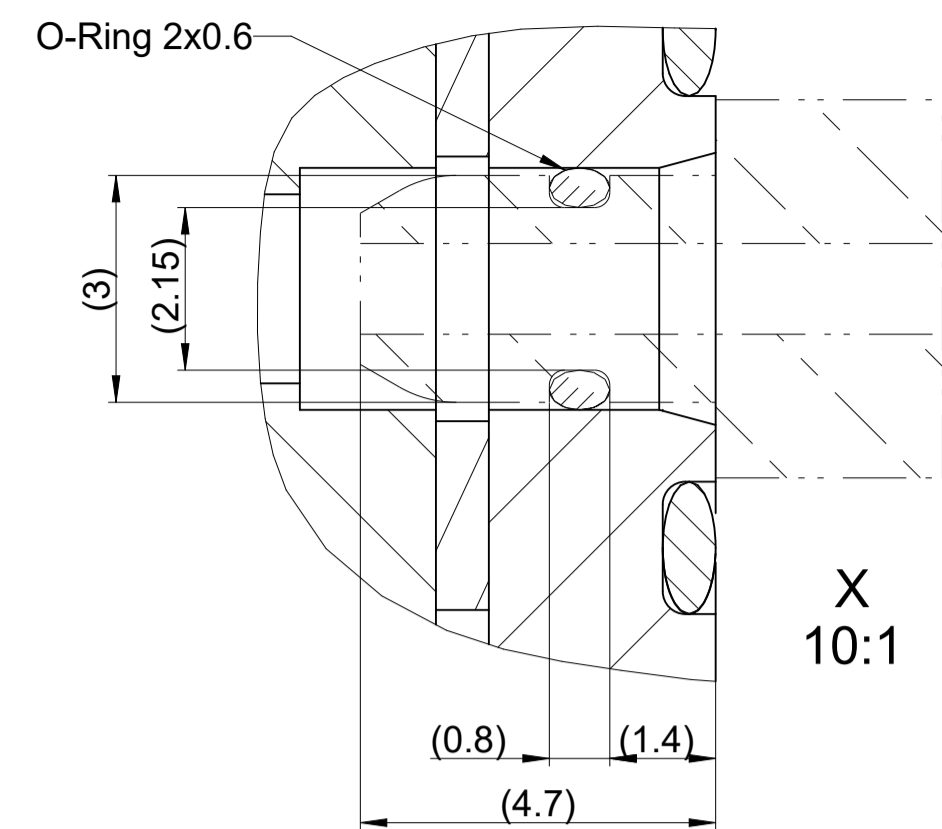

CZ Stroke

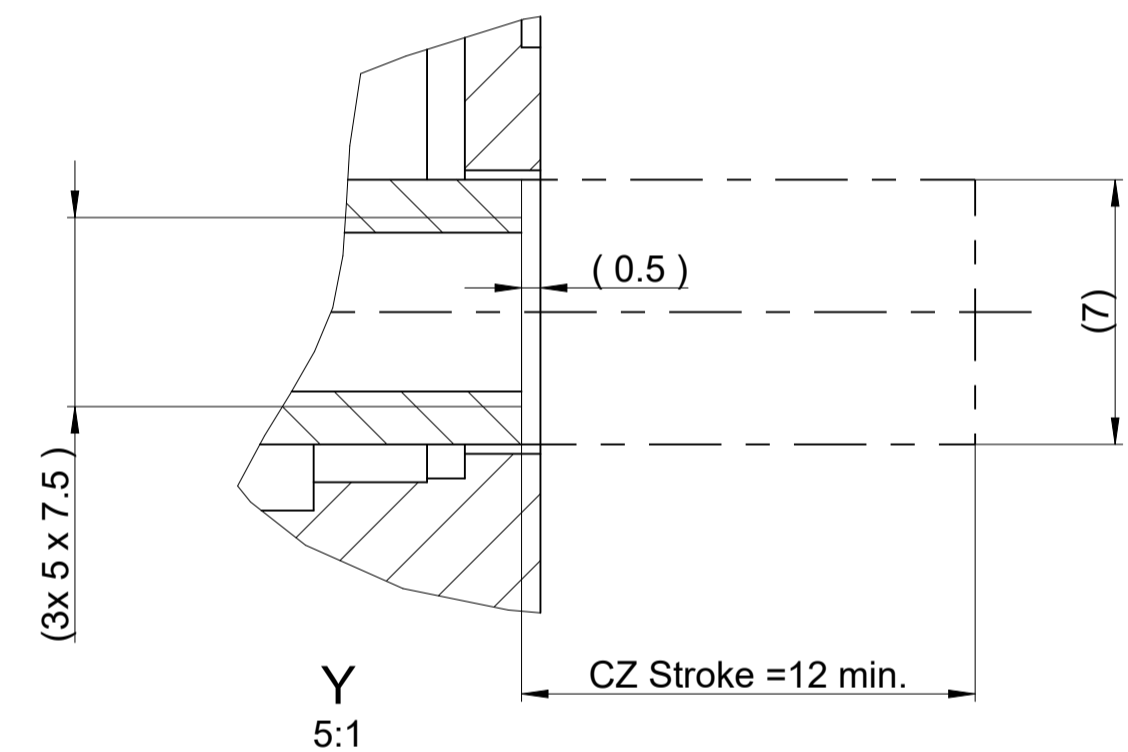

T Stroke limited

- Option 65° min.
- Option 125° min.
- Option 185° min.
- Option 245° min.
- Option 305° min.

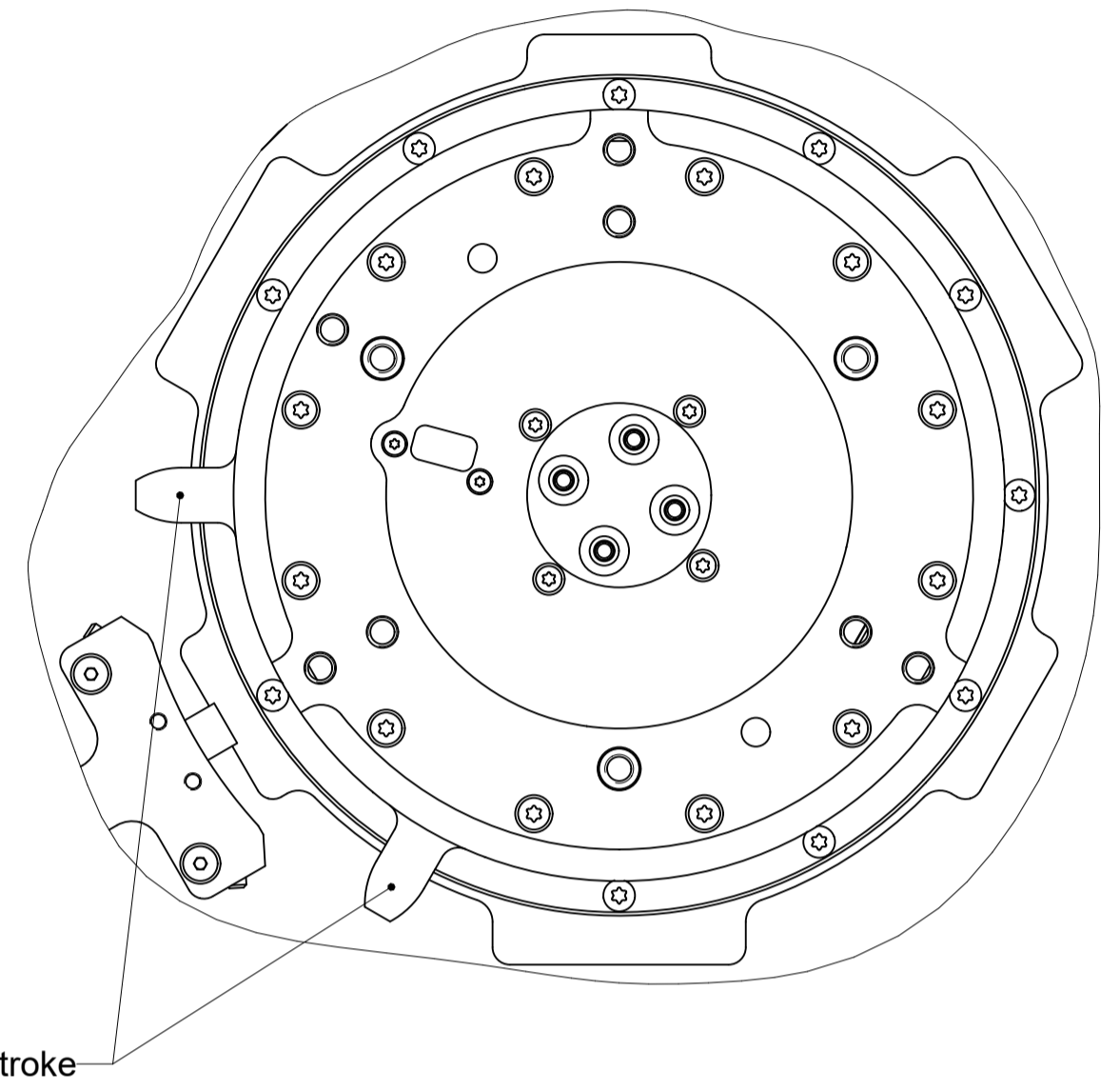

Pogo Connector 8 Pins on rotative part

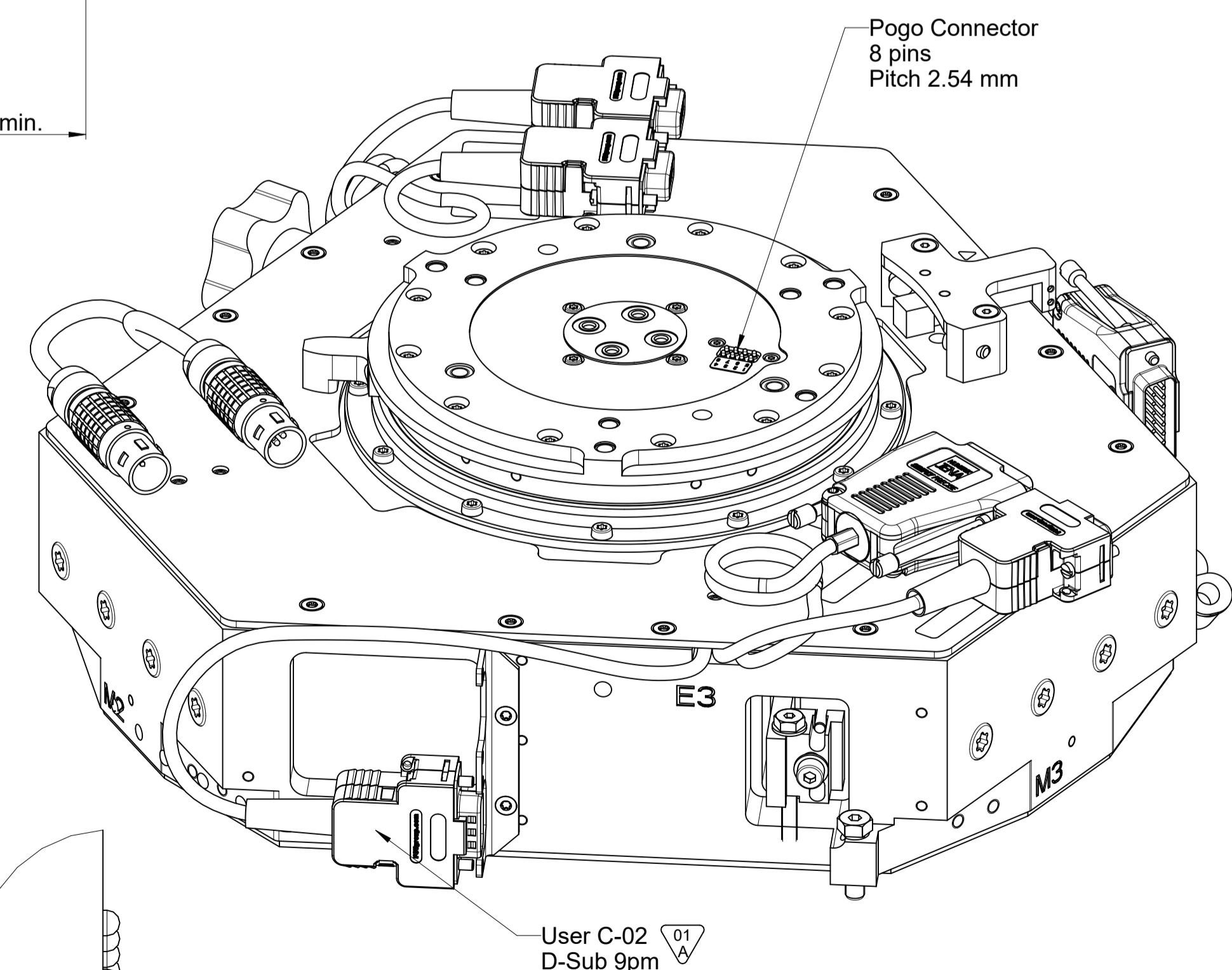
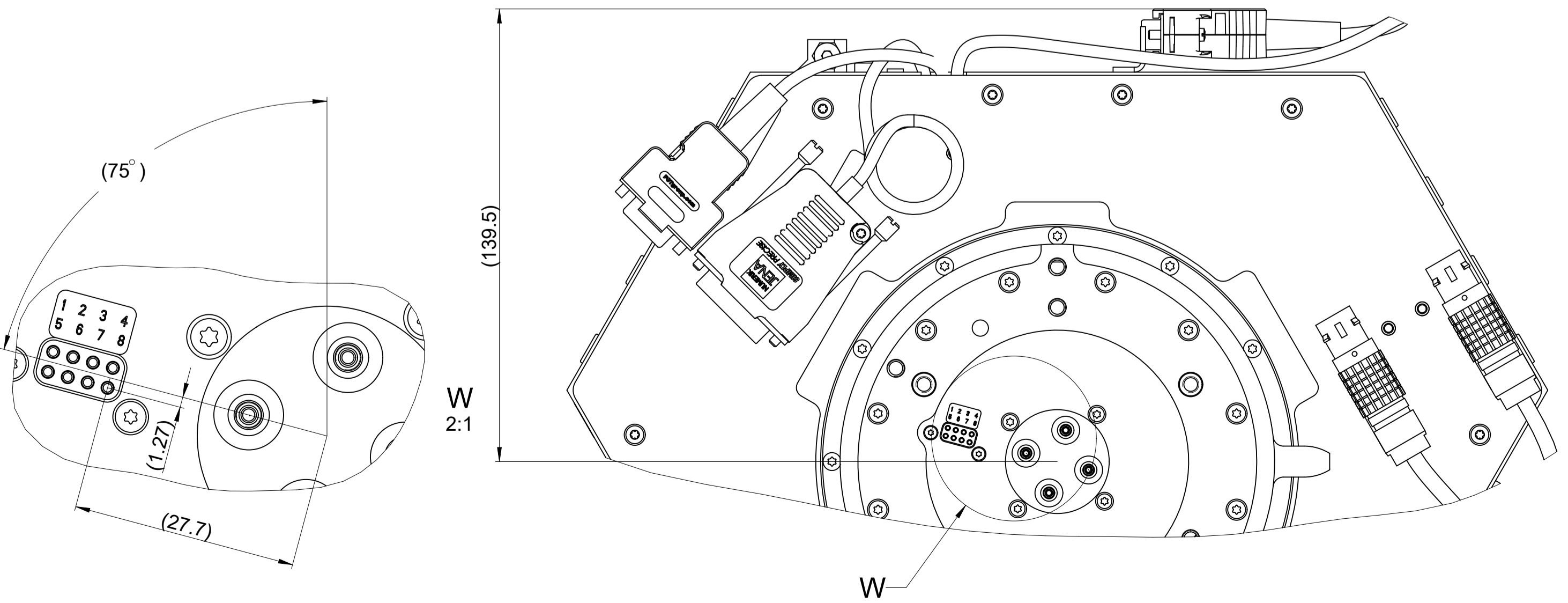

Text: Change orientation User C01 and C02 D-sub + add note screw penetration max		ID number: 1324806-
Change No. C138130-05		Released: 16-Mar-22
Tolerances as per ISO 8015 : 2011 Tolérances selon ISO 8015 : 2011		Dimensions without tolerance Dimensions sans tolérances
The reproduction, distribution and utilization of this document as well as the communication of its contents to others without express authorization is prohibited. Offenders will be held liable for the payment of damages. All rights reserved in the event of the grant of a patent, utility model or design. (ISO 18015)		Version   Revision   Sheet   Page
<b>ETEL</b> ETEL S.A. 2112 Möllers SWITZERLAND		<b>1326462-01 - A-01</b> Document number

# Wobble adjustment kit

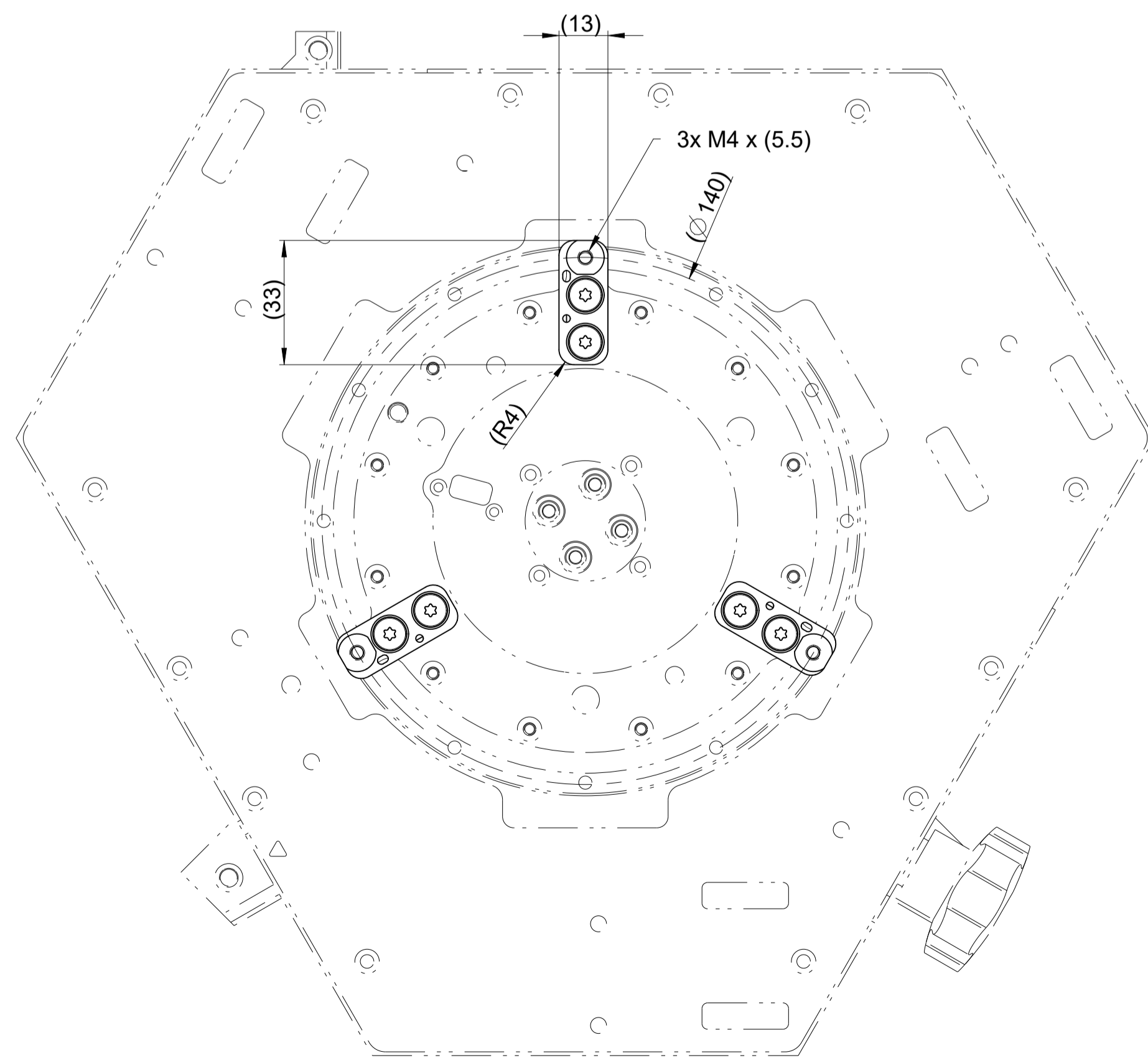
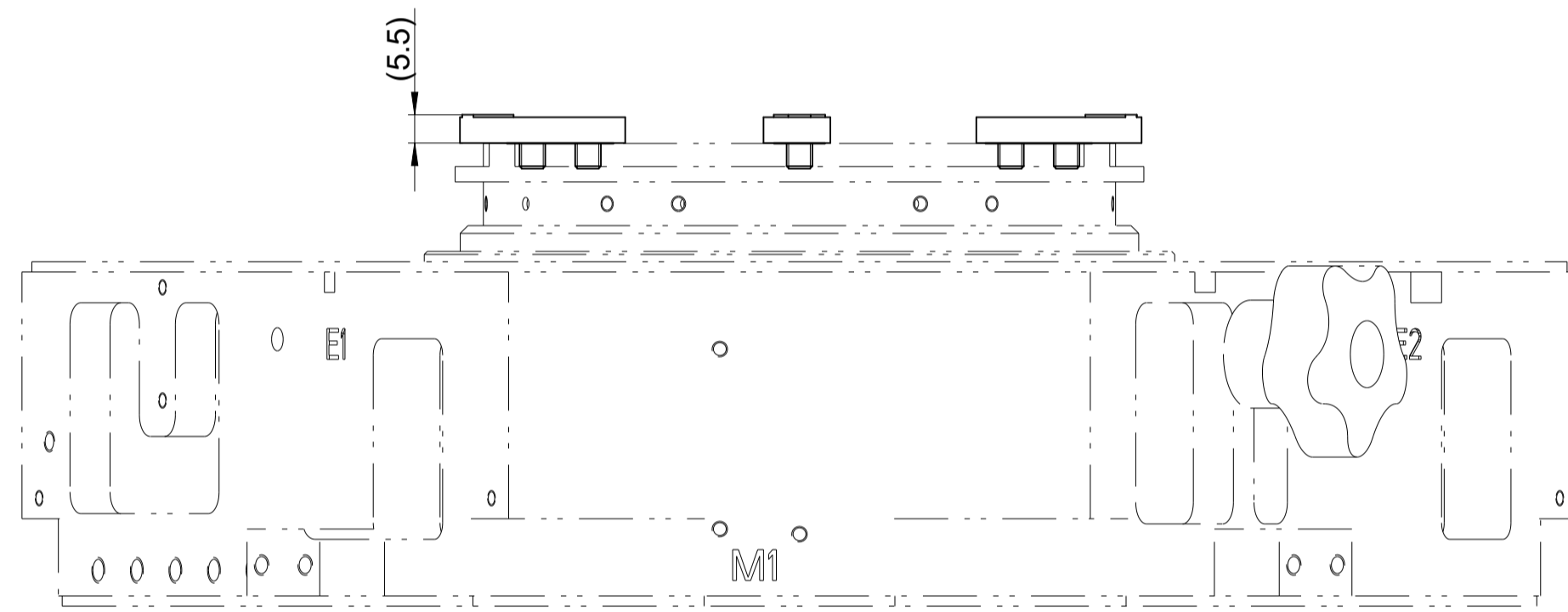
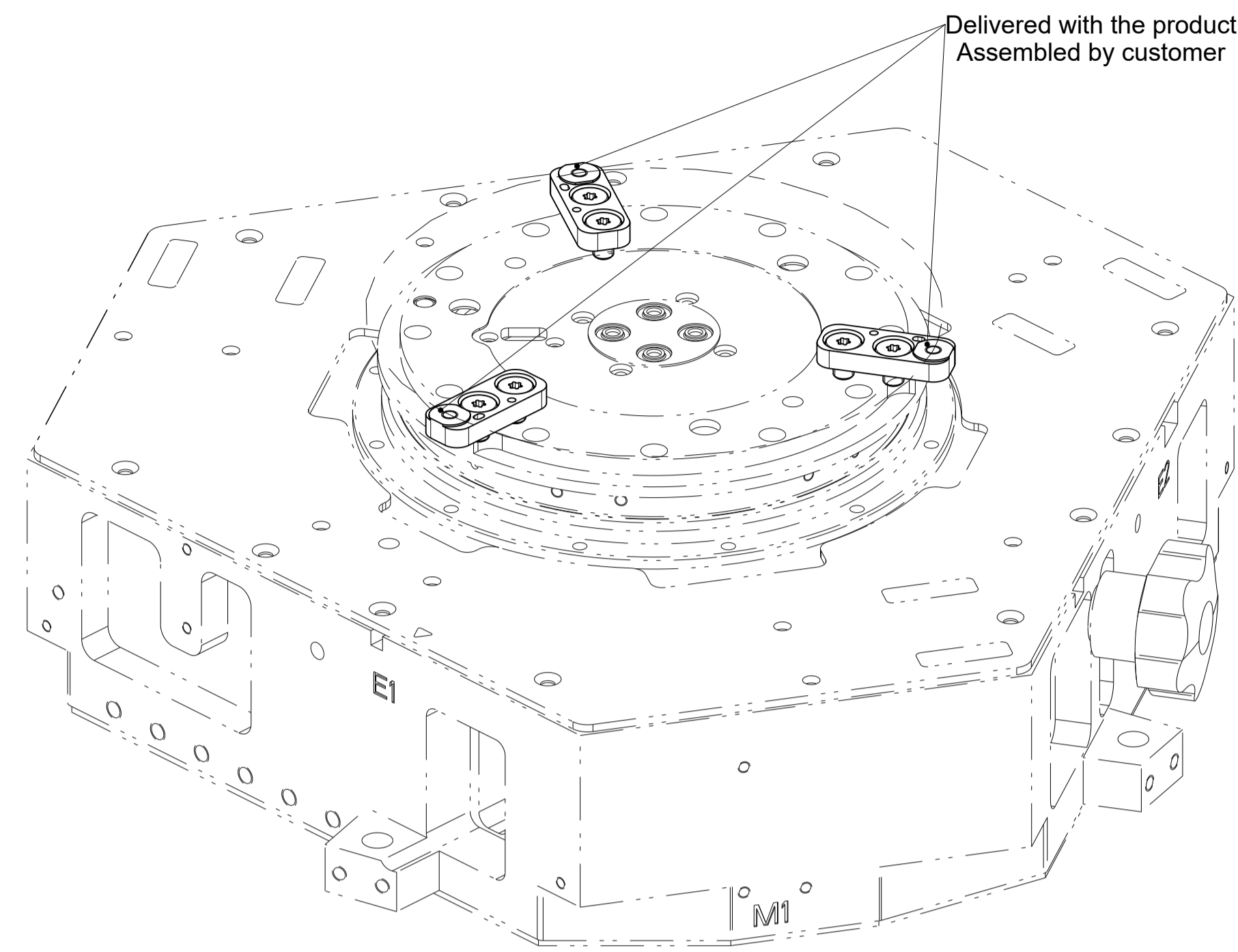

# Vacuum 2

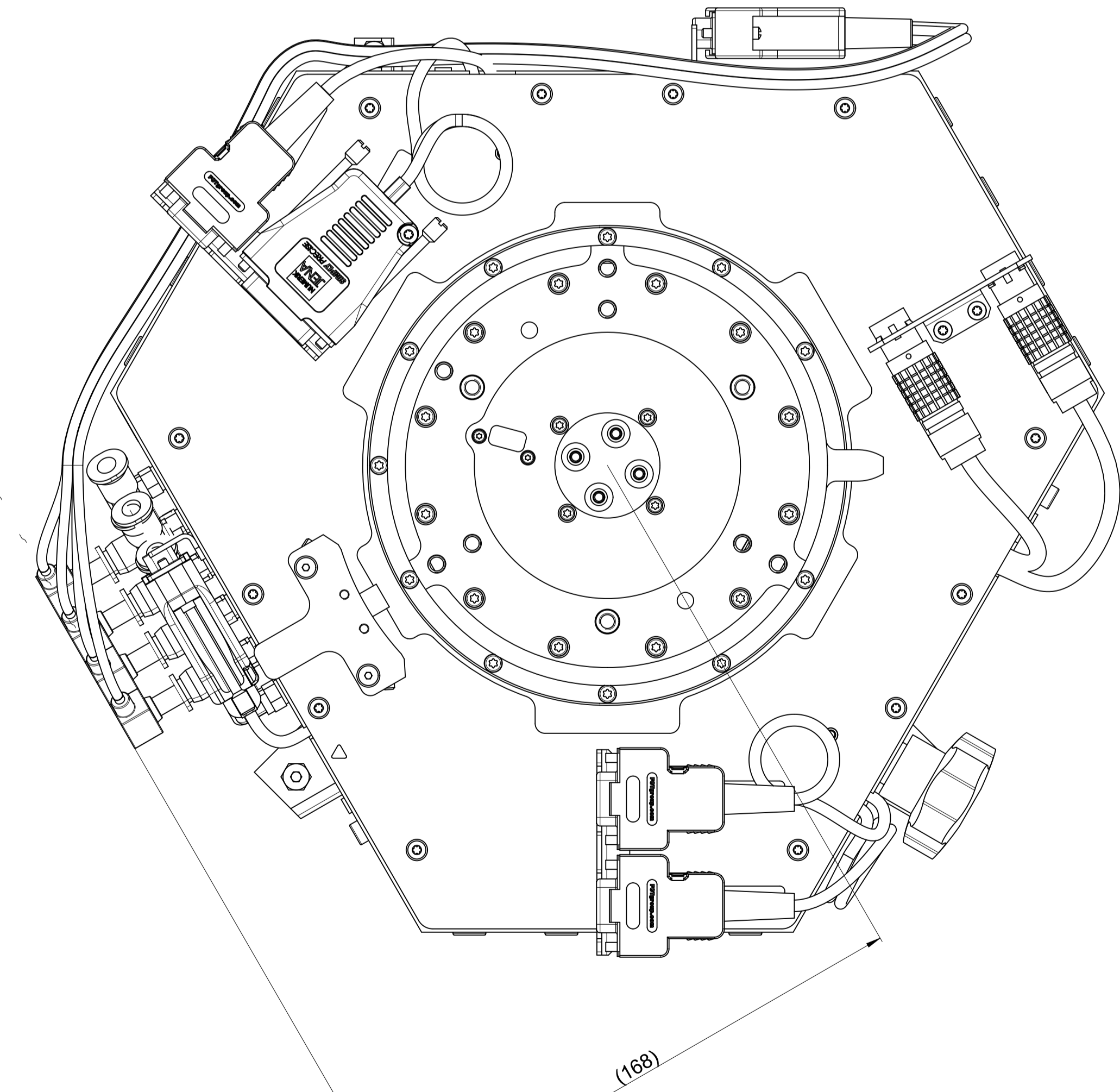
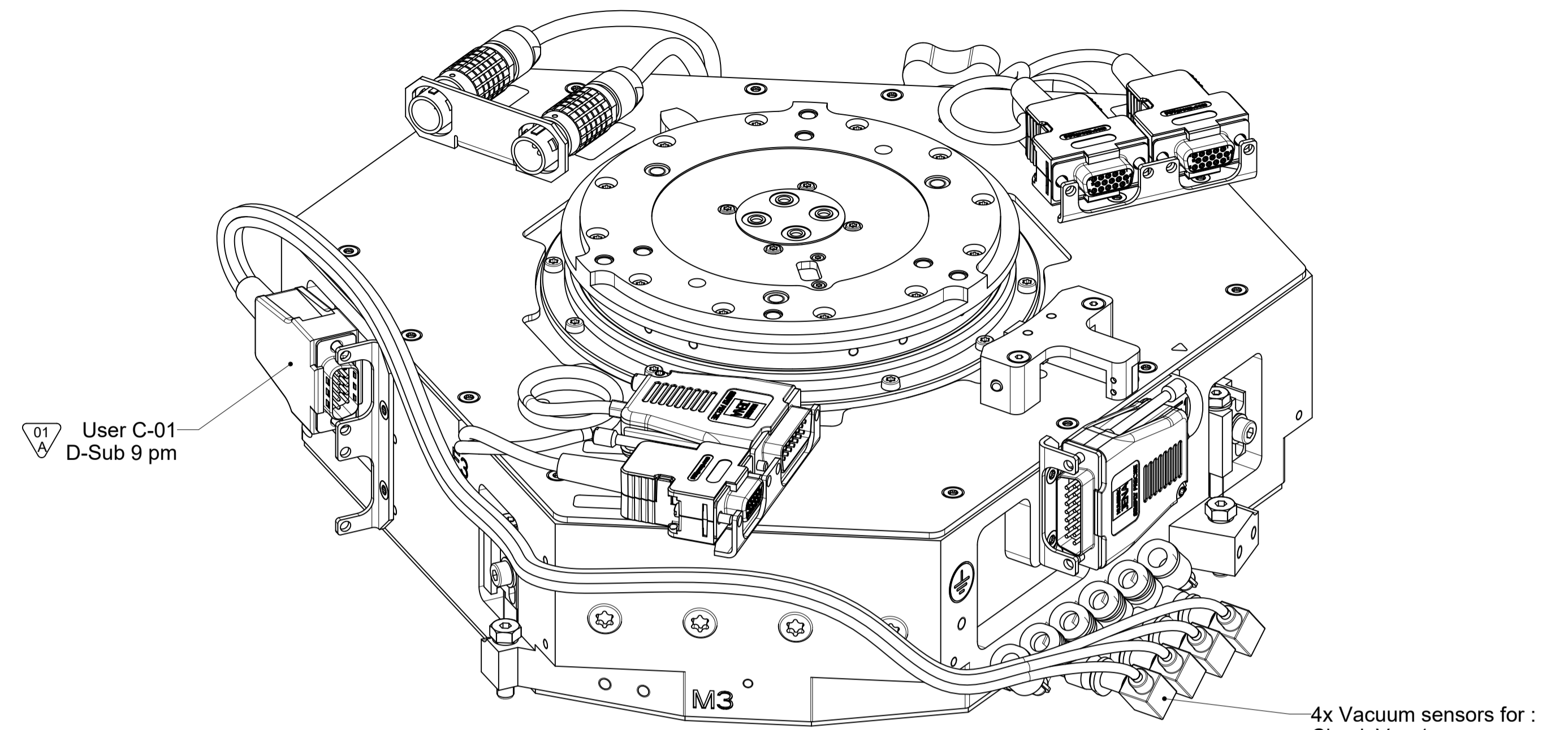

Text: Change orientation User C01 and C02 D-sub + add note screw penetration max		ID number: 1324806-
Change No. C138130-05		Released: 16-Mar-22
Tolerances as per ISO 8015 : 2011 Tolérances selon ISO 8015 : 2011		Dimensions without tolerance Dimensions sans tolérances
Original drawing	Scale: 4:5	Format: A1
Multi axis system Z3TM+ Système multi-axes Z3TM+		Version   Revision   Sheet   Page
Mating Dimensions / Coles d'encorement		1326462-01 - A-01
ETEL S.A. 2112 Möllers SWITZERLAND		3 of 3